

INLGB04IRA

4.1 MP Vandal Proof Motorized Lens Bullet Camera with IR, 2.8-12mm

- High quality image with 4MP, 1/3" CMOS sensor
- Digital Wide Dynamic Range
- H.265+ & H.264 encoding
- Smart IR, up to 30m (98ft) IR distance
- Supports Micro SD card up to 256GB



Legend: Smarter, Stronger, Fully NDAA Compliant

The INLGB04IRA is a 4.1MP vandal-proof bullet camera with a motorized 2.8–12mm lens and a 1/3" CMOS sensor, delivering clear, high-quality images. It features Digital Wide Dynamic Range, Smart IR with up to 30m (98ft) night vision, supports H.265+ and H.264 encoding for efficient video compression, and includes a Micro SD slot for up to 256GB of local storage.

Dimensions

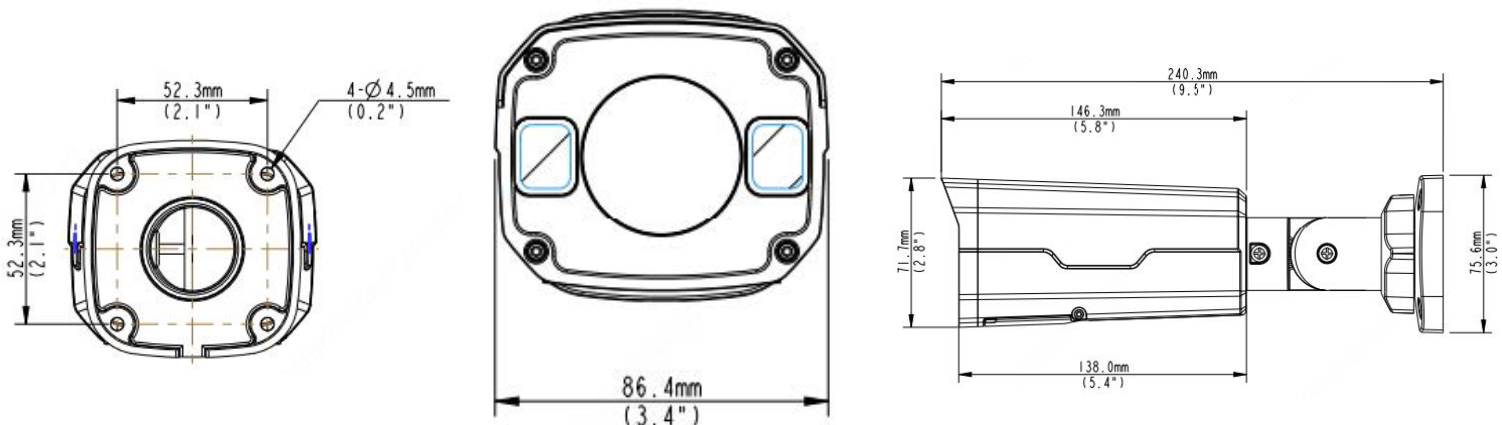

*Design and specifications are subject to change without notice.

Camera					
Image Sensor	1/3", 4.0 megapixel, progressive scan, CMOS				
Minimum Illumination	Colour: 0.01 lux (F1.6, AGC ON), 0 lux with IR				
Day/Night	IR-cut filter with auto switch (ICR)				
Electronic Speed Shutter	Auto/Manual, 1 ~ 1/100000s				
Pan/Tilt/Rotate	Pan: 0° ~ 360°	Tilt: 0° ~ 90°	Rotate: 0° ~ 360°		
WDR	DWDR				
S/N Ratio	More than 52 dB				
Illumination					
IR Range	Up to 30m/98ft				
Wavelength	850nm				
IR On & Off Control	Auto/Manual				
Lens					
Focal Length	2.8 ~ 12mm, motorized zoom lens				
Iris	F1.6				
Viewing Angle (H, V, D)	H: 91.0° ~ 27°	V: 54.4° ~ 13.7°	O: 118.3° ~ 33.2°		
DORI					
DORI Distance	Lens (mm)	Detect	Observe	Recognize	Identify
	2.8	63m/ 206.7 ft	25.2m/ 82.7 ft	12.6m/ 41.3 ft	6.3m/ 20.7 ft
	12	270m/ 885.8 ft	108m/ 354.3 ft	54m/ 177.2 ft	27m/ 88.6 ft
Video					
Compression		H.265+ / H.265 / H.264 / MJPEG			
H.264 code profile		Baseline profile, Main profile			
Frame Rate		Main Stream: 4MP (2592*1520), Max 20fps; Sub Stream: 720P (1280*720), Max 20fps; Third Stream: D1 (704*576), Max 20fps			
Video Bit Rate		128 Kbps ~ 16Mbps			
On-Screen Display (OSD)		Up to 4 OSDs			
Privacy Mask		Up to 4 areas			
Region of Interest		Up to 2 areas			
Video Stream		Triple			
U-code		Supported			
Image					
White Balance		Auto/Outdoor/Fine Tune/Sodium Lamp/Locked/Auto2			
Digital Noise Reduction		2D/3D DNR			
Flip		Normal/Vertical/Horizontal/180°			
Image Features		Smart IR, Highlight Compensation, Backlight Compensation, Motion detection			

*Design and specifications are subject to change without notice.

Audio	
Audio Compression	G.711U, G.711A
Audio Bit Rate	64 Kbps
Sampling Rate	8KHZ
Audio Features	Suppression
Storage	
Edge Storage	Micro SD, up to 256GB
Network Storage	ANR
Interface	
Ethernet	1*RJ45 10M/100M Base-TX Ethernet
Network	
Protocols	IPv4, IGMP, ICMP, ARP, TCP, UDP, DHCP, RTP, RTSP, RTCP, DNS, DDNS, NTP, FTP, UPnP, HTTP, HTTPS, SMTP, SSL, QoS
Compatibility	ONVIF (Profile S, G, T), API
User and host	Up to 32 users with 2 user levels: administrator and common user
Security	Password protection, Strong password, HTTPS encryption, Export operation logs, Basic and digest authentication for RTSP, Digest authentication for HTTP, TLS 1.2, WSSE and digest authentication for ONVIF
Management Software	LEGEND VMS, ARKIV
Web Browser	Plug-in required for live view in: IE9+, Chrome 41+, Firefox 52+
	Plug-in free live view: Chrome 57+, Firefox 58+, Edge 16+, Safari 11+
Certifications	
CE: EN 60950-1 UL: UL60950-1 FCC: FCC Part 15	
Protection	IP67 (IEC 60529), 6KV (Surge Protection)
General	
Power	DC 12V±25%, PoE (IEEE 802.3af)
Power Consumption	Less than 7.0W
Power Interface	Ø 5.5mm coaxial power plug
Dimensions (L x W x H)	240.3 × 86.4 × 75.6mm / 9.46" × 3.4" × 2.98"
Weight	1kg / 2.2lb
Material	Metal
Working Environment	-30°C ~ 60°C (-22°F ~ 140°F), Humidity: ≤95% RH (non-condensing)

*Design and specifications are subject to change without notice.

Accessories



XLGJB06-A
Junction Box



XLGJB07-D
Junction Box



XLGUP06-B
Pole Mount

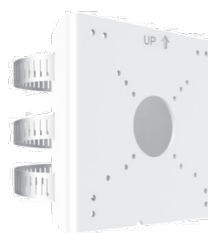

XLGUP06-C
Pole Mount



VUSD256G
Micro SD Card

Accessories Mount

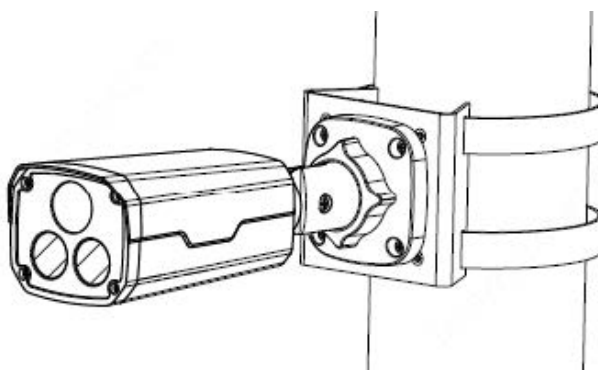

Pole Mount
XLGUP06-B

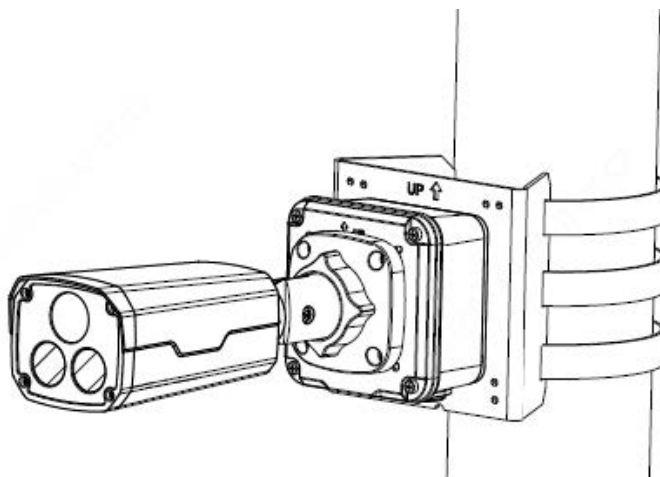

Junction Mount
XLGJB07-D (XLGJB06-A) + XLGUP06-C

*Design and specifications are subject to change without notice.